







“Hidden behind a façade of vertical timbers, The Grim House is a masterclass in architectural reinvention. Once a modest two-up, two-down terrace from the 1980s, this three-bedroom, three-bathroom home has been wholly transformed by Checa Romero Architects into a beautifully indulgent retreat—a cabinet of curiosities that ingeniously balances light, space, and detail.”

From the outset, you're greeted by an illusion of solidity. The timber-clad exterior wraps around the house like a protective stockade, but look closer, and it reveals its secret: a series of concealed openings, allowing light to flood inside.

The home now features two entrances—one, the primary door leading into a spine-like, top-lit hallway; the other, tucked in where the original front door once stood, offers direct access to a front room that cleverly doubles as an office or guest suite.

Inside, the transformation continues with a new steel and concrete structure that unbinds the layout. Full-height openings blur the boundaries between rooms, allowing the space to flow seamlessly from one area to the next.

The eye is drawn to the rear of the house, where the extension is cloaked in rich Cor-ten steel, softened by creeping plants and the calming trickle of a water feature, creating a urban courtyard garden that contrasts beautifully with the bright, white interiors.



The kitchen is a study in minimalist design—low-horizon cabinetry floats against the walls, keeping sightlines clear, while skylights and floor-to-ceiling glazing flood the space with natural light. Yet the innovation doesn't stop here. A lower ground floor, accessible via a moulded concrete staircase, offers a versatile space for family living.

Throughout the house, light is manipulated with deft precision. Skylights and lightwells drop beams of daylight through the heart of the home, while concealed storage, built-in furniture, and intricate detailing evoke the compact luxury of a ship's cabin or a 1930s studio flat.

The Grim House is an example of architecture as art. It transcends the conventional, offering not just more space but a home that tells a story—one of curiosity, craftsmanship, and an unwavering commitment to pushing the boundaries of what's possible in domestic architecture.







The area around Brick Lane in East London is a vibrant cultural hub, known for its rich history, eclectic street art, and diverse community. Once famous for its textiles and markets, it has evolved into a hotspot for vintage shops, galleries, and trendy cafés, while still retaining its historic charm. The area is also renowned for its curry houses and food markets, reflecting the blend of cultures that shape its unique character. With a lively atmosphere, Brick Lane is a destination for art lovers, foodies, and anyone looking to experience the creative energy of London's East End.























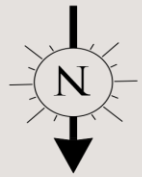

Underwood Road

E1

£1,350,000

FREEHOLD
COUNCIL TAX BAND D
EPC RATING TBC

- Redesigned by Checa Romero Architects
- Three bedrooms
- Three bathrooms
- Bespoke kitchen
- Dinesen flooring
- Underfloor heating
- Interior designed
- Large windows
- Bespoke storage throughout
- Close to Brick Lane
- Allocated parking

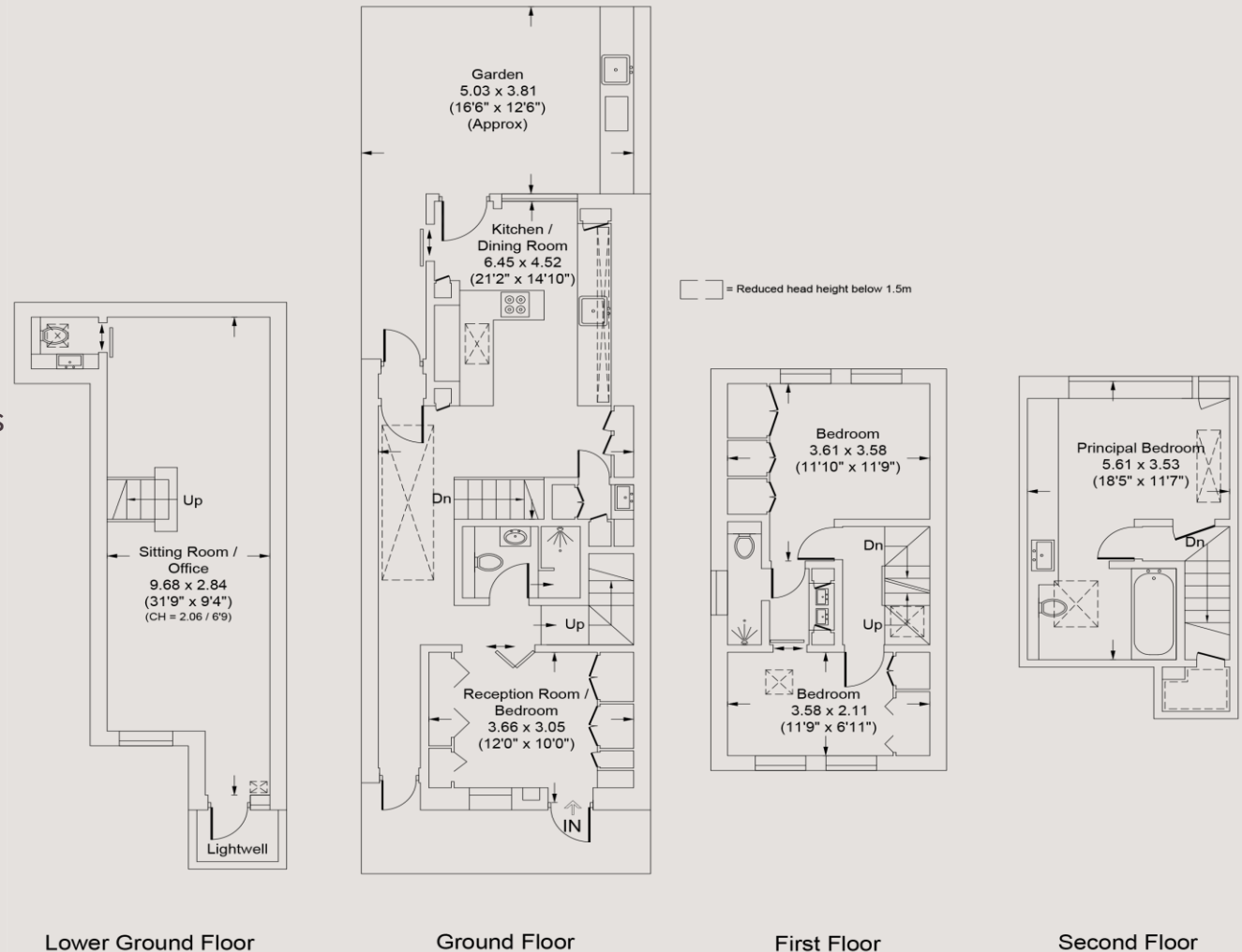

Lower Ground Floor

Ground Floor

First Floor

Second Floor

0207 867 3999
hello@storyofhome.co.uk
www.storyofhome.co.uk

**Story
of Home**
Beautiful homes, by design

Approx Gross Internal Area
Limited Use Area

1338 Sq Ft - 124.3 Sq M
15 Sq Ft - 1.4 Sq M

For Illustration Purposes Only - Not To Scale

Every attempt has been made to ensure the accuracy of this floor plan however measurements are approximate and for illustration purposes only.

Measured in accordance with the RICS code of measuring practice. Not to scale.